

Tube Cap
SM-C

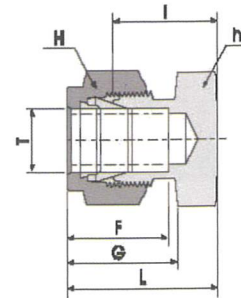

UNIT:mm

Part No.	Tube OD	h	H	F	G	I	L
	T(mm)						
SM-C2	1/8	12	11	12.7	15.2	13.5	20.1
SM-C4	1/4	12	14	15.2	17.8	16.0	23.4
SM-C6	3/8	16	17	16.8	19.3	18.3	25.7
SM-C8	1/2	20	22	22.9	21.8	19.1	29.2
SM-C10	5/8	24	27	24.4	21.8	19.8	30.0
SM-C12	3/4	27	30	24.4	21.8	21.3	31.5
SM-C16	1	35	33	31.2	26.4	26.2	38.4

UNIT:mm

Part No.	Tube OD	h	H	F	G	I	L
	T(mm)						
SM-C4M	4	12	12	13.7	16.1	14.7	21.3
SM-C6M	6	12	14	15.3	17.7	15.7	23.1
SM-C8M	8	14	16	16.2	18.6	17.0	24.5
SM-C10M	10	17	19	17.2	19.5	19.0	26.6
SM-C12M	12	20	22	22.8	22.0	19.0	29.1
SM-C15M	15	24	27	24.4	22.0	19.8	29.9
SM-C16M	16	24	27	24.4	22.0	19.8	31.9