

## Bulkhead Male Connector SM-BMC

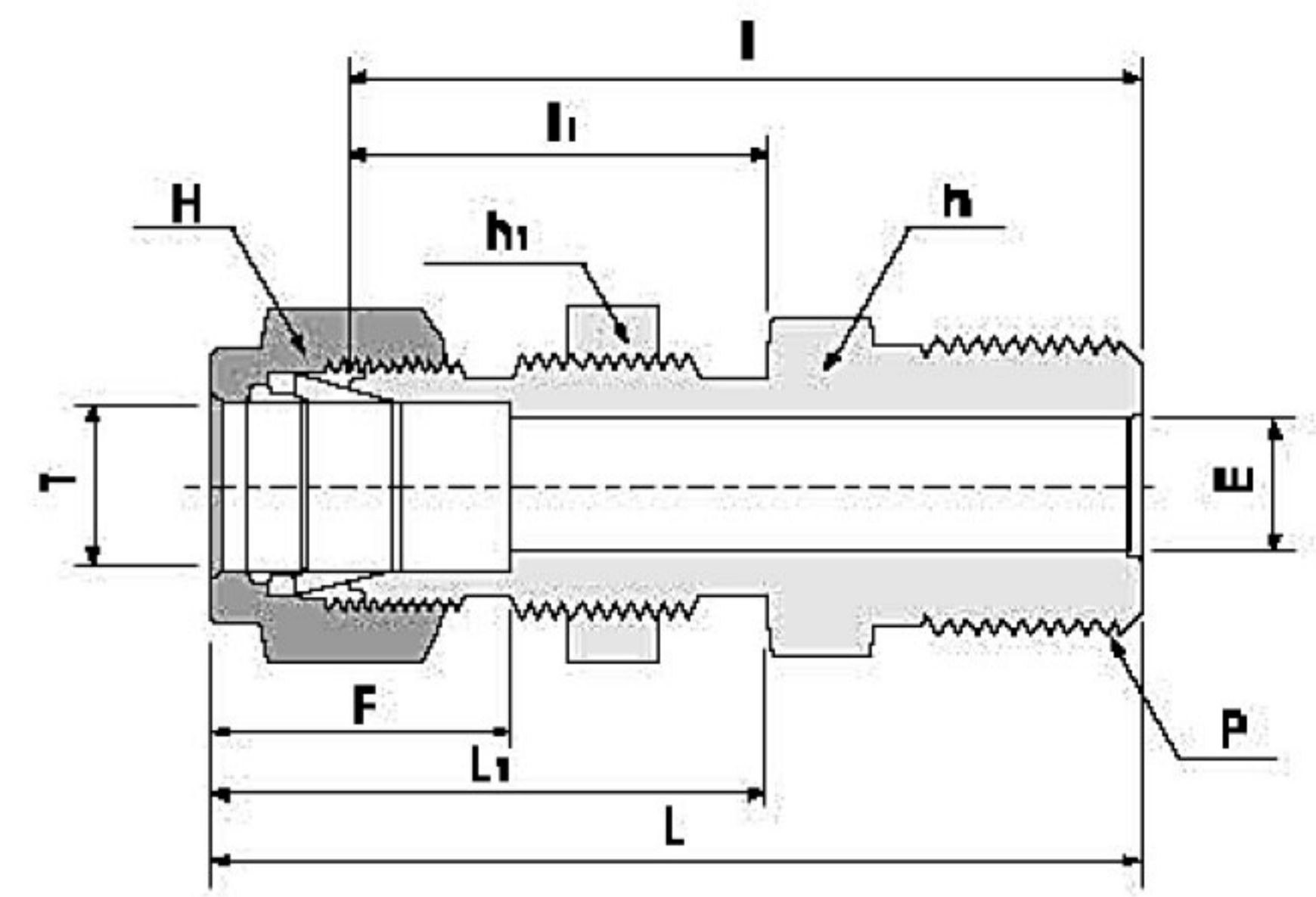

UNIT:mm

Part No.	Tube O.D.	P	E Min	h	h1	H	F	I1	I	L1	L	Panel Hole Diill Size	Max Panel Thickness
	T(inch)												
SM-BMC2-2T	1/8	1/8	2.5	12	12	11	12.7	24.6	39.9	31.2	46.5	8.3	12.7
SM-BMC4-2T	1/4	1/8	5	16	16	14	15.2	26.2	42.2	33.5	49.5	11.5	10.2
SM-BMC4-4T	1/4	1/4	5	16	16	14	15.2	26.2	45.0	33.5	52.3	11.5	10.2
SM-BMC6-4T	3/8	1/4	8	19	19	17	16.8	28.0	48.0	36.8	55.4	14.7	11.2
SM-BMC8-6T	1/2	3/8	10	24	24	22	22.9	31.8	53.1	41.9	63.2	19.4	12.7
SM-BMC8-8T	1/2	1/2	10	24	24	22	22.9	31.8	56.7	41.9	66.8	19.4	12.7

UNIT:mm

Part No.	Tube O.D.	P	E Min	h	h1	H	F	I1	I	L1	L	Panel Hole Diill Size	Max Panel Thickness
	T(mm)												
SM-BMC6M-2T	6	1/8	5	16	16	14	15.3	26.2	42.2	33.6	49.5	11.5	10.2
SM-BMC6M-4T	6	1/4	5	16	16	14	15.3	26.2	45.0	33.6	52.3	11.5	10.2
SM-BMC8M-4T	8	1/4	6	17	17	16	16.2	28.6	48.0	36.1	55.4	13.1	11.2
SM-BMC12M-6T	12	3/8	10	24	24	22	22.9	31.8	53.1	41.9	63.2	19.5	12.7
SM-BMC12M-8T	12	1/2	10	24	24	22	22.9	31.8	56.7	41.9	66.8	19.5	12.7