

**Female Elbow
SM-FE**

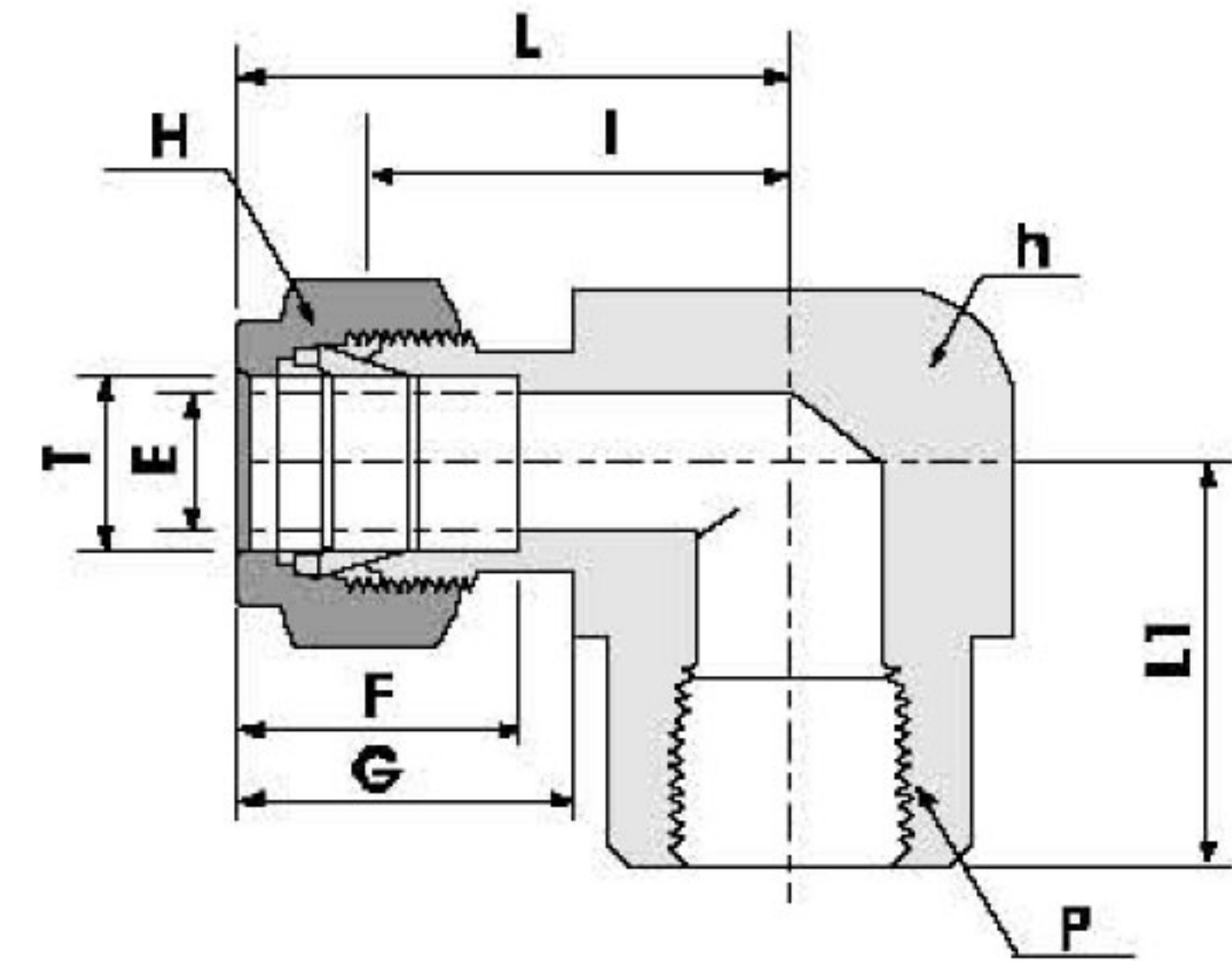

UNIT:mm

Part No.	Tube O.D.	P	E Min	h	H	F	G	I	L	L1
	T(inch)									
SM-FE2-2T	1/8	1/8	2.5	14	12	12.7	15.2	18.0	24.6	19.1
SM-FE2-4T	1/8	1/4	2.5	17	12	12.7	15.2	20.8	27.4	22.4
SM-FE4-2T	1/4	1/8	5	14	14	15.2	17.8	19.6	26.9	19.1
SM-FE4-4T	1/4	1/4	5	17	14	15.2	17.8	22.4	29.7	22.4
SM-FE4-6T	1/4	3/8	5	23	14	15.2	17.8	24.4	31.8	22.4
SM-FE4-8T	1/4	1/2	5	27	14	15.2	17.8	27.2	34.5	28.4
SM-FE6-2T	3/8	1/8	8	14	17	16.8	19.3	23.1	30.5	19.1
SM-FE6-4T	3/8	1/4	8	17	17	16.8	19.3	23.9	31.2	22.4
SM-FE6-6T	3/8	3/8	8	23	17	16.8	19.3	25.9	33.3	22.4
SM-FE6-8T	3/8	1/2	8	27	17	16.8	19.3	28.7	36.1	28.4
SM-FE8-4T	1/2	1/4	10	20	22	22.9	21.8	27.3	36.1	22.4
SM-FE8-6T	1/2	3/8	10	23	22	22.9	21.8	27.3	36.1	22.4
SM-FE8-8T	1/2	1/2	10	27	22	22.9	21.8	28.7	38.9	28.4
SM-FE10-6T	5/8	3/8	12	23	27	24.4	21.8	27.9	38.1	22.4
SM-FE10-8T	5/8	1/2	12	27	27	24.4	21.8	29.7	39.9	28.4
SM-FE12-8T	3/4	1/2	16	27	30	24.4	21.8	29.7	39.9	28.4
SM-FE12-12T	3/4	3/4	16	35	30	24.4	21.8	34.5	44.7	31.8
SM-FE16-12T	1	3/4	22	35	38	31.2	26.4	36.8	49.0	31.8



**Female Elbow
SM-FE**

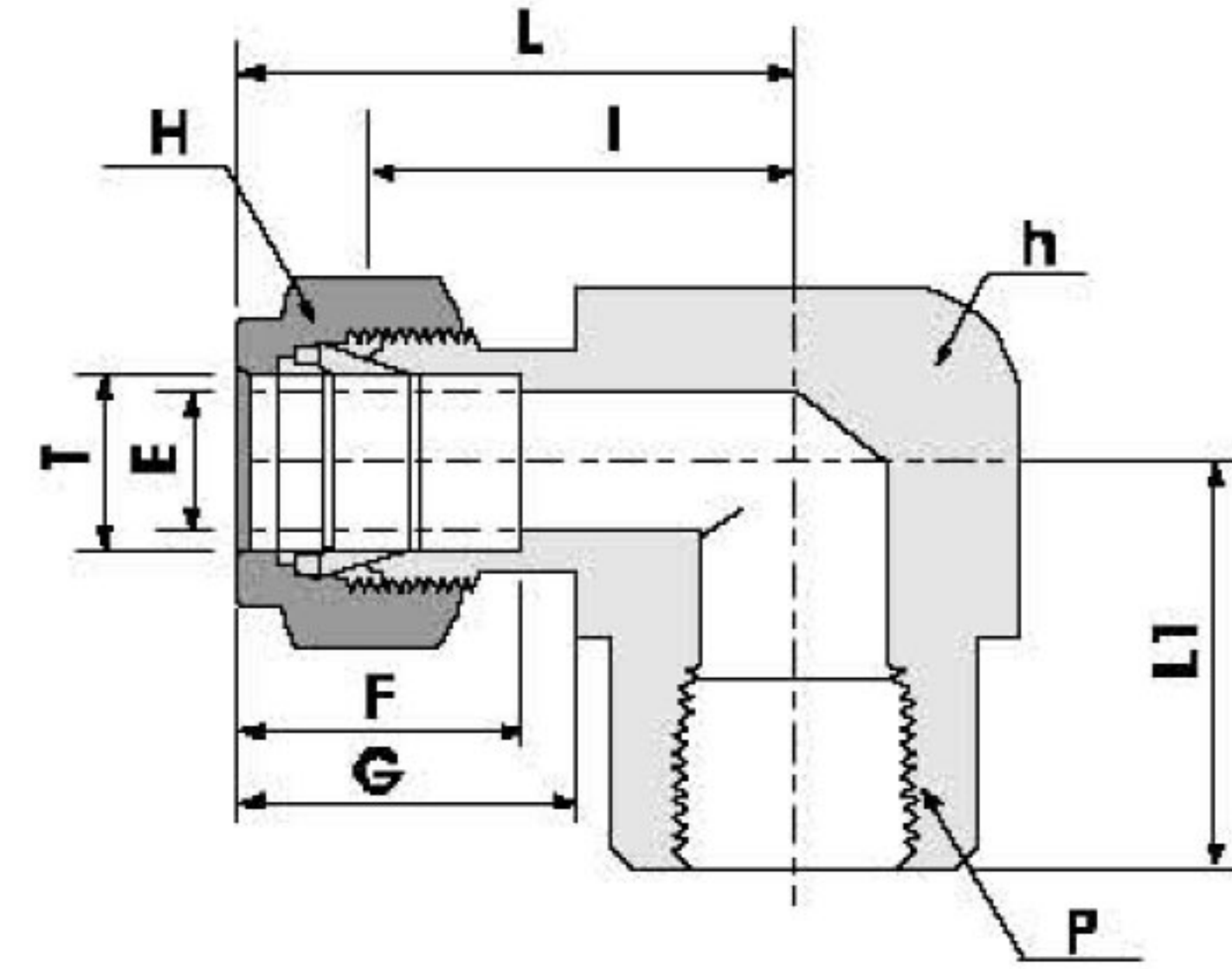

UNIT:mm

Part No.	Tube O.D.	P	E Min	h	H	F	G	I	L	L1
	T(mm)									
SM-FE4M-2T	4	1/8	2.5	14	12	13.7	16.1	18.8	25.4	19.1
SM-FE6M-2T	6	1/8	5	14	14	15.3	17.7	19.6	26.9	19.1
SM-FE6M-4T	6	1/4	5	17	14	15.3	17.7	22.4	29.7	22.4
SM-FE6M-6T	6	3/8	5	23	14	15.3	17.7	24.4	31.8	22.4
SM-FE6M-8T	6	1/2	5	27	14	15.3	17.7	27.2	34.5	28.4
SM-FE8M-2T	8	1/8	6.	14	17	16.2	18.6	21.3	28.7	19.1
SM-FE8M-4T	8	1/4	6.	17	17	16.2	18.6	23.1	30.5	22.4
SM-FE12M-4T	12	1/4	10	20	22	22.8	22.0	27.3	36.1	22.4
SM-FE12M-6T	12	3/8	10	23	22	22.8	22.0	27.3	36.1	22.4
SM-ME12M-8T	12	1/2	10	27	22	22.8	22.0	28.7	38.9	28.4
SM-ME15M-6T	16	3/8	12	27	27	24.4	22.0	27.9	38.1	22.4
SM-ME15M-8T	16	1/2	12	27	27	24.4	22.0	32.0	39.9	28.4